

Body Parts List/ Lista de partes

Part N° N° de Pieza	Name Nombre	Qty. Cant.
1	Body Side L/R	2
2	Inner body side	2
3	Body Top	1
4	Shelf	2
5	Bottom Stretcher	1
6	Shelves Concealer	2
7	Concealer	2
8	Top Stretcher	2
19	Shelf Tube	4
21a	Stop	2

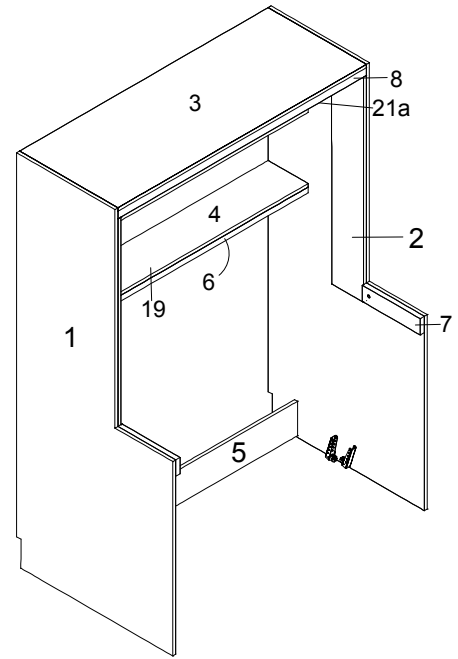

Bed Parts List/ Lista de partes

9	Bed Side	2
10	Bed Feet	1
11	Bed Head	1
12	Slats Cleats	2
13	---	---
20	Bed Cover	1
22	Slat Cleat B	1

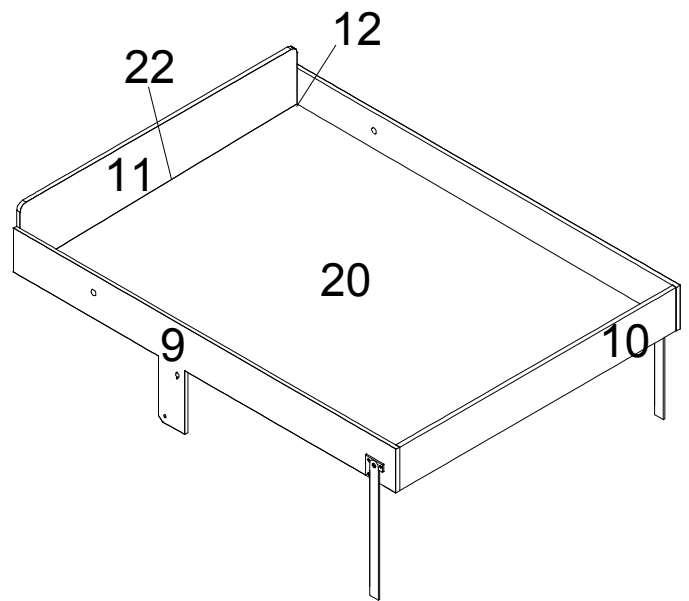

Desk Parts List/ Lista de partes

14	Desk Side	2
15	Desk Top	1
16	Desk Back	1
17	Desk Tube Cover	1
18	Desk Tube	1
21b	Wood Plug	2

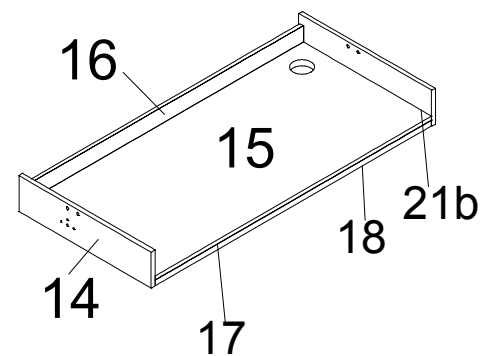

Manufacturer to verify adequate drilling diameter and depth for screw or dowel length in every place.
 El fabricante deberá verificar el adecuado diámetro y profundidad de las perforaciones para cada tornillo o tarugo.

+

Drill to drive a screw position

○

Drill for screw through position.

Name	Code	Dimension	Quantity	Sketch
Confirmat	H2	7 x 70	41	
Round Head Allen & T nut	H12	6 X 30	6	
Screw, Ph Head	H10	4,5 x 45	20	
Screw, Ph head	H4	3,5 x 16	4	
Flat Head Allen & T nut	H11	6 x 15	32	
Dowel		10 x 30	34	
Minifix	H44	REFERENCE HAFFLE'S 262.17.710 AND 262.27.029	5	
Screw, Ph head	H14	4,5x35	78	
Screw, Ph head	H9	4,5x20	8	

Drawing	Screw	Quantity
1	H2 H11	20 32
2	H9	6
3	 H14	4 12
4		8
5		2
6	H14	12
7	H14	4
8	---	---
9	H2 H4 H12	8 4 6
10		4
11		4
12	H10	20
13	---	---
14	H2 H9	10 2
15		4
16	H2	3
17	H44	5
18	---	---
19	H14	16
20	H14	30
21	H14 	4 4
22		4
	TOTAL	228

BED POSITION

DESK POSITION

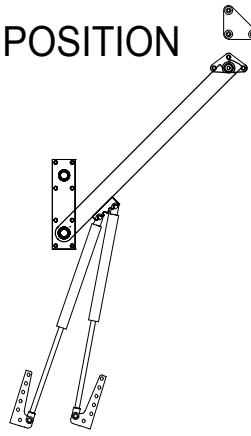
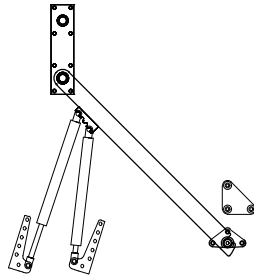

MECHANISM FIXING

S2 SCREWS RESUME:
(INCLUDED IN S1)

Carapaces

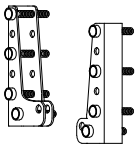

Name	Code	Dimension	Quantity	Sketch
Flat Head Allen & T nut	H11	6 x 15	16	

Plate

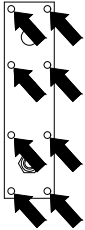

Name	Code	Dimension	Quantity	Sketch
Flat Head Allen & T nut	H11	6 x 15	16	

Tribearer

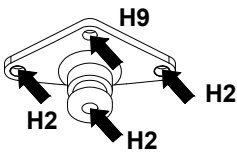

Name	Code	Dimension	Quantity	Sketch
Screw, Ph head	H9	4,5x20	2	
Confirmat	H2	7 x 70	6	

Leg

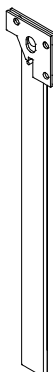

Name	Code	Dimension	Quantity	Sketch
Round Head Allen & T nut	H12	6 x 30	6	

DESK POSITION

TD 06 MA 1500 x 1900 CQU

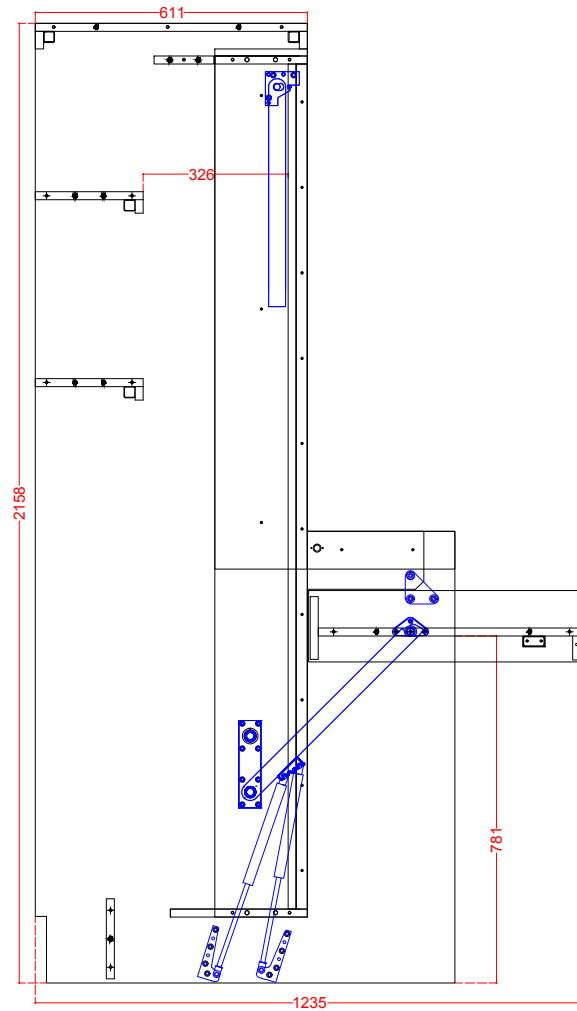
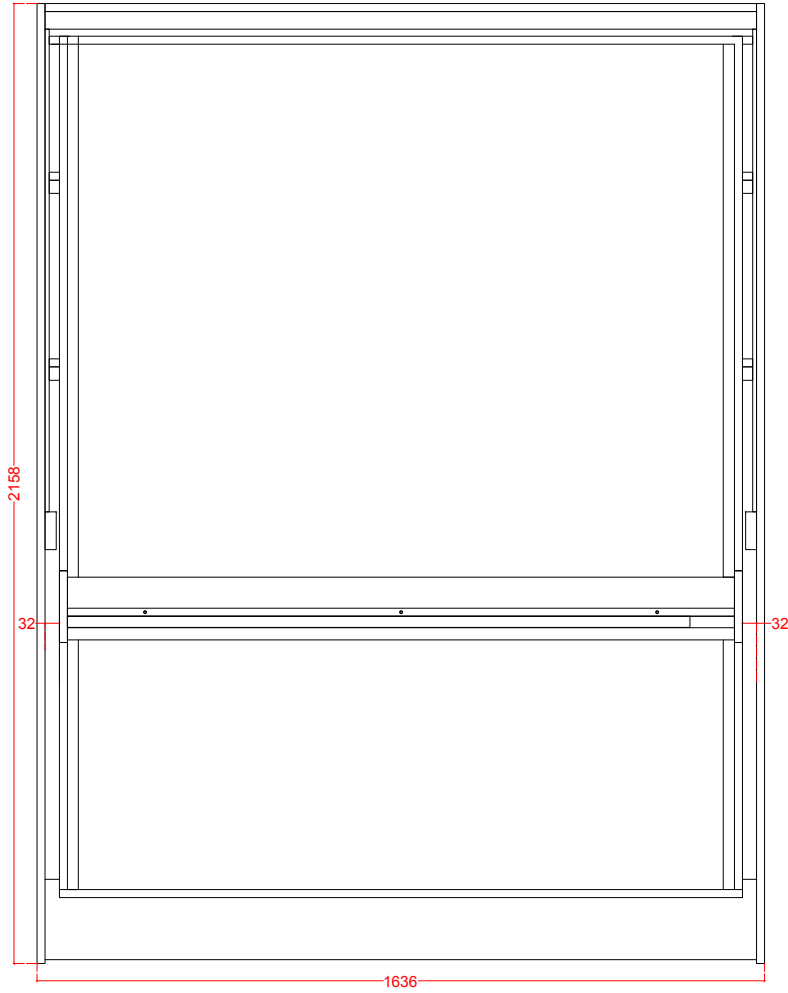

CONFIDENTIAL DRAWINGS
ALL REPRODUCTION PROHIBITED



DATE
FECHA

Vancouver

CODE NUMBER
N° DE CÓDIGO

MA 1900-1500-348-326

PART N°
N° DE PARTE

B

BED POSITION

TD 06 MA 1500 x 1900 CQU

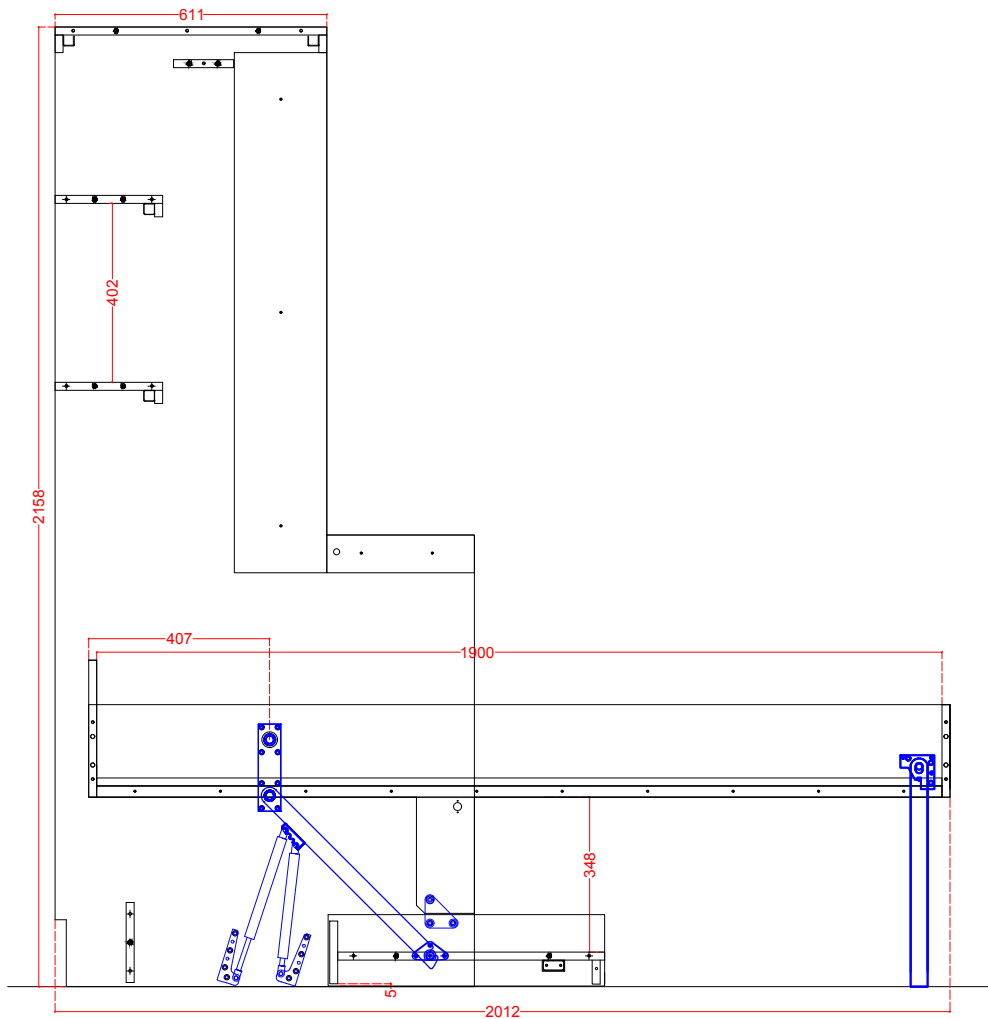
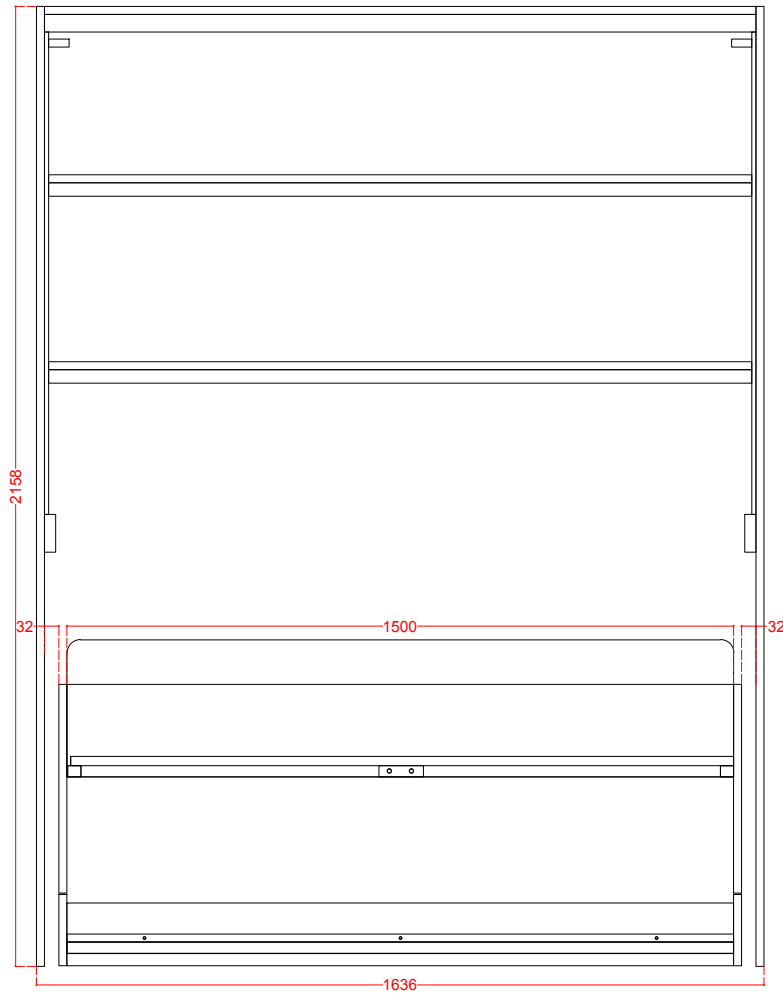

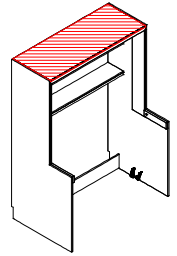

Part: Body Top (3)

Material: MDF

Thick: 18mm

Quantity: 1

SCREW HEADS

	4
H14	12



PERFORATION

A	3	2
B	5.5	70
C	10	22
D	5	PASS

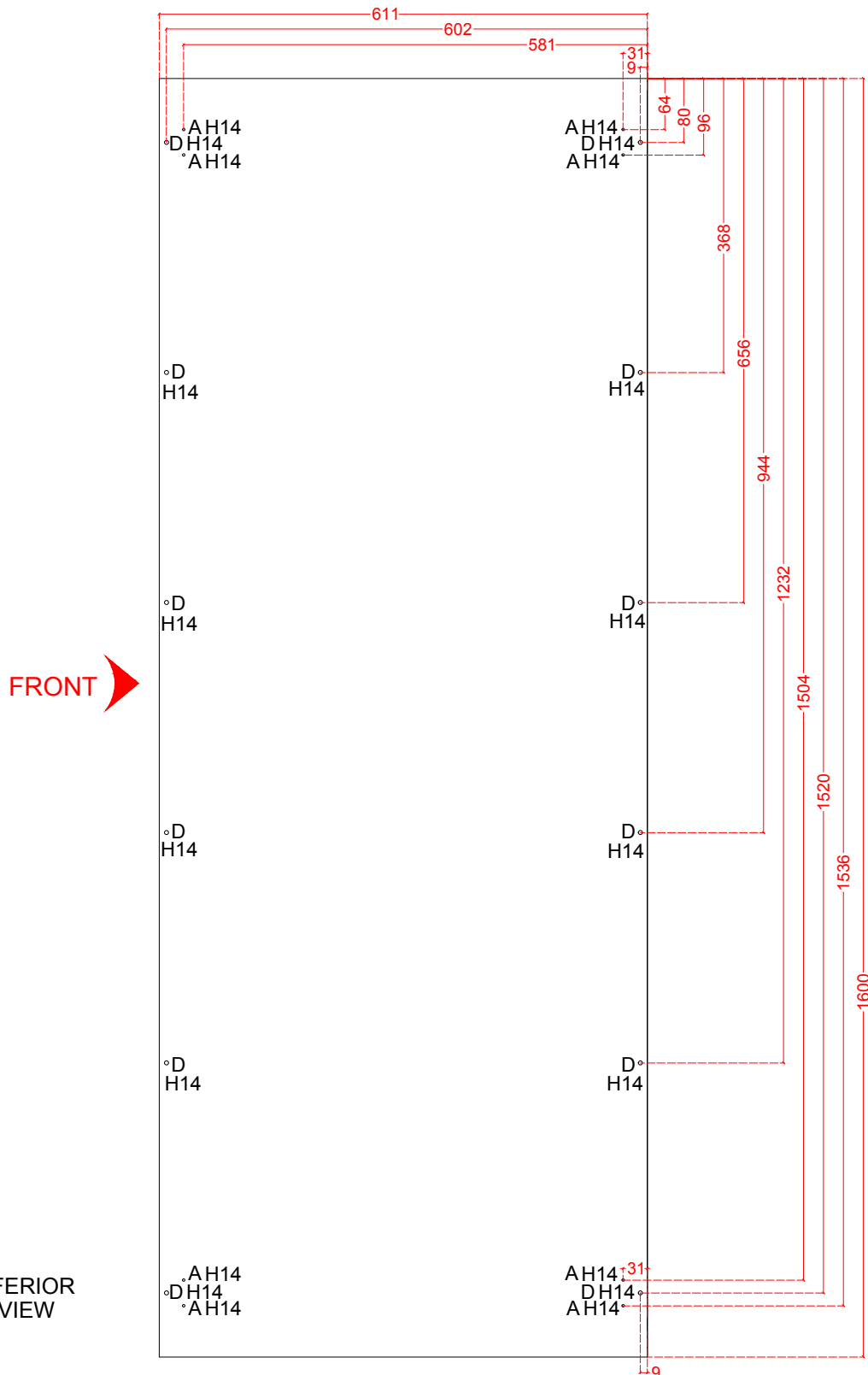

FRONT

VISTA INFERIOR
BOTTOM VIEW

BOTH ENDS
AMBOS EXTREMOS

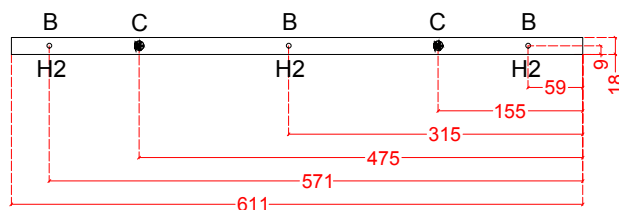

CONFIDENTIAL DRAWINGS
ALL REPRODUCTION PROHIBITED

Mecanismo Vancouver

TD 06 MA 1500 x 1900 CQU

MA 1900-1500-348-326

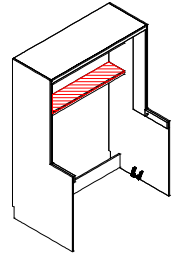

Part: Shelf (4)

Material: MDF

Thick: 18mm

Quantity: 2

SCREW HEADS

○ 4 X 2

*

PERFORATION

A	3	2
B	5.5	70
C	10	22

FRONT

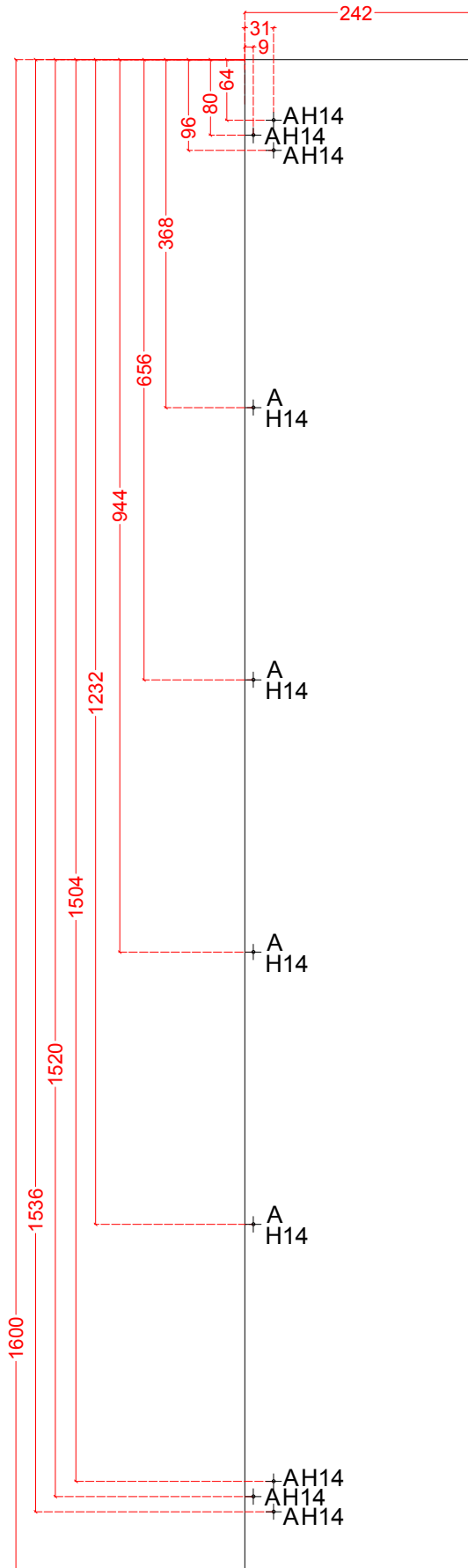

BOTH ENDS
AMBOS EXTREMOS

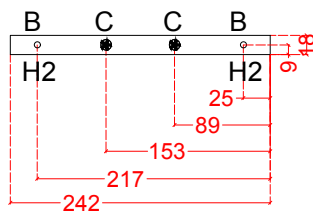

CONFIDENTIAL DRAWINGS
ALL REPRODUCTION PROHIBITED

Mecanismo Vancouver

TD 06 MA 1500 x 1900 CQU

MA 1900-1500-348-326

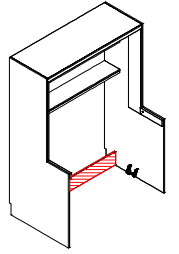

Part: Bottom Stretcher (5)

Material: MDF

Thick: 18mm

Quantity: 1

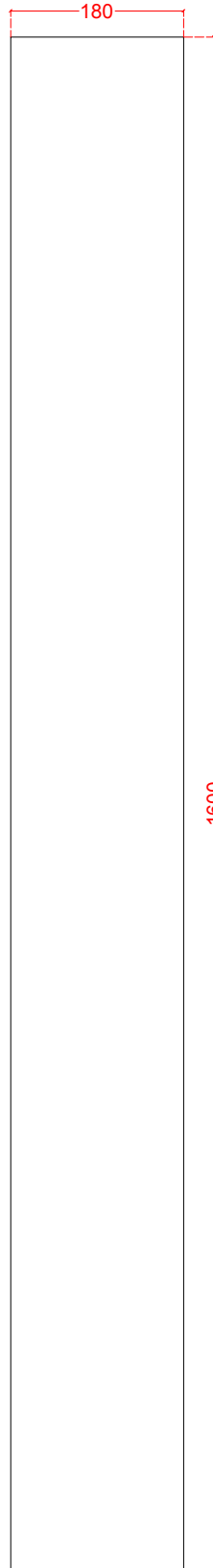

SCREW HEADS

	2
---	---

*

PERFORATION

A	5.5	70
B	10	22

BOTH ENDS
AMBOS EXTREMOS

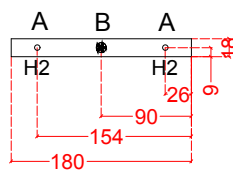

CONFIDENTIAL DRAWINGS
ALL REPRODUCTION PROHIBITED

Mecanismo Vancouver

TD 06 MA 1500 x 1900 CQU

MA 1900-1500-348-326

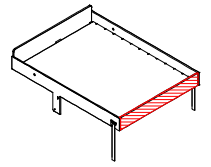

Part: Bed Feet (10)

Material: MDF

Thick: 18mm

Quantity: 1

SCREW HEADS



4



PERFORATION

A	5.5	70
B	10	22
C	10	10

TOP

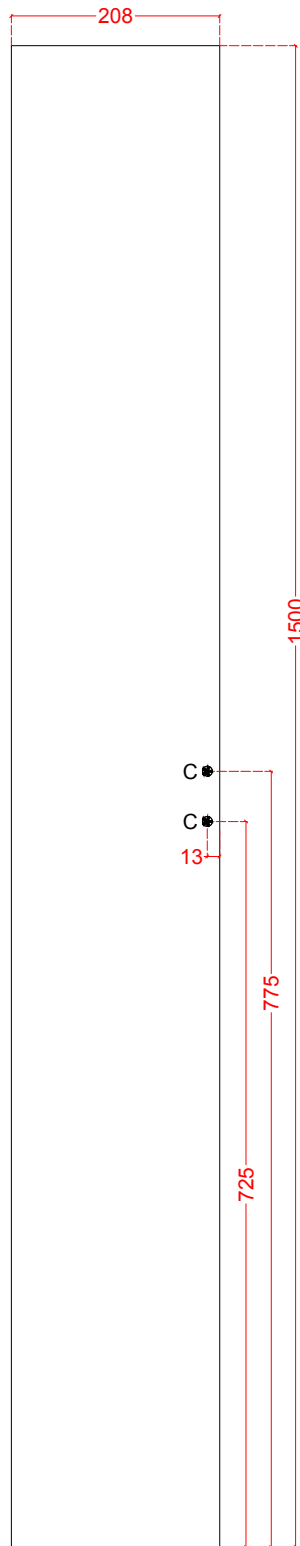

BOTH ENDS
AMBOS EXTREMOS

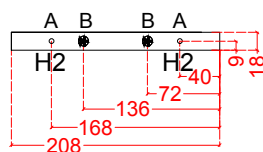

CONFIDENTIAL DRAWINGS
ALL REPRODUCTION PROHIBITED

Mecanismo Vancouver

TD 06 MA 1500 x 1900 CQU

MA 1900-1500-348-326

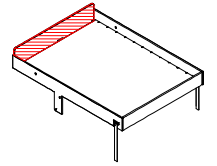

Part: Bed Head (11)

Material: MDF

Thick: 18mm

Quantity: 1

SCREW HEADS

	4
---	---



PERFORATION

A	5.5	70
B	10	22
C	10	10

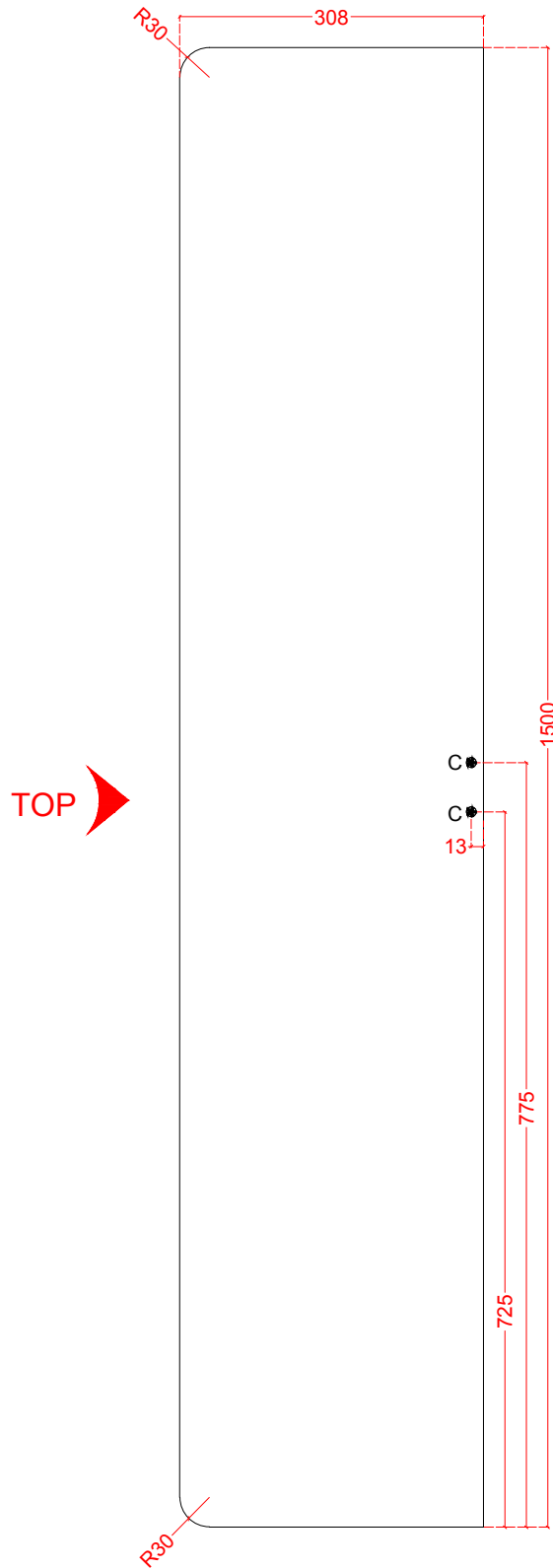

**BOTH ENDS
AMBOS EXTREMOS**

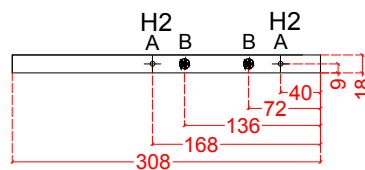

CONFIDENTIAL DRAWINGS
ALL REPRODUCTION PROHIBITED

Mecanismo Vancouver

TD 06 MA 1500 x 1900 CQU

MA 1900-1500-348-326

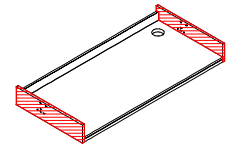

Part: Desk Side (14)

Material: MDF

Thick: 18mm

Quantity: 2

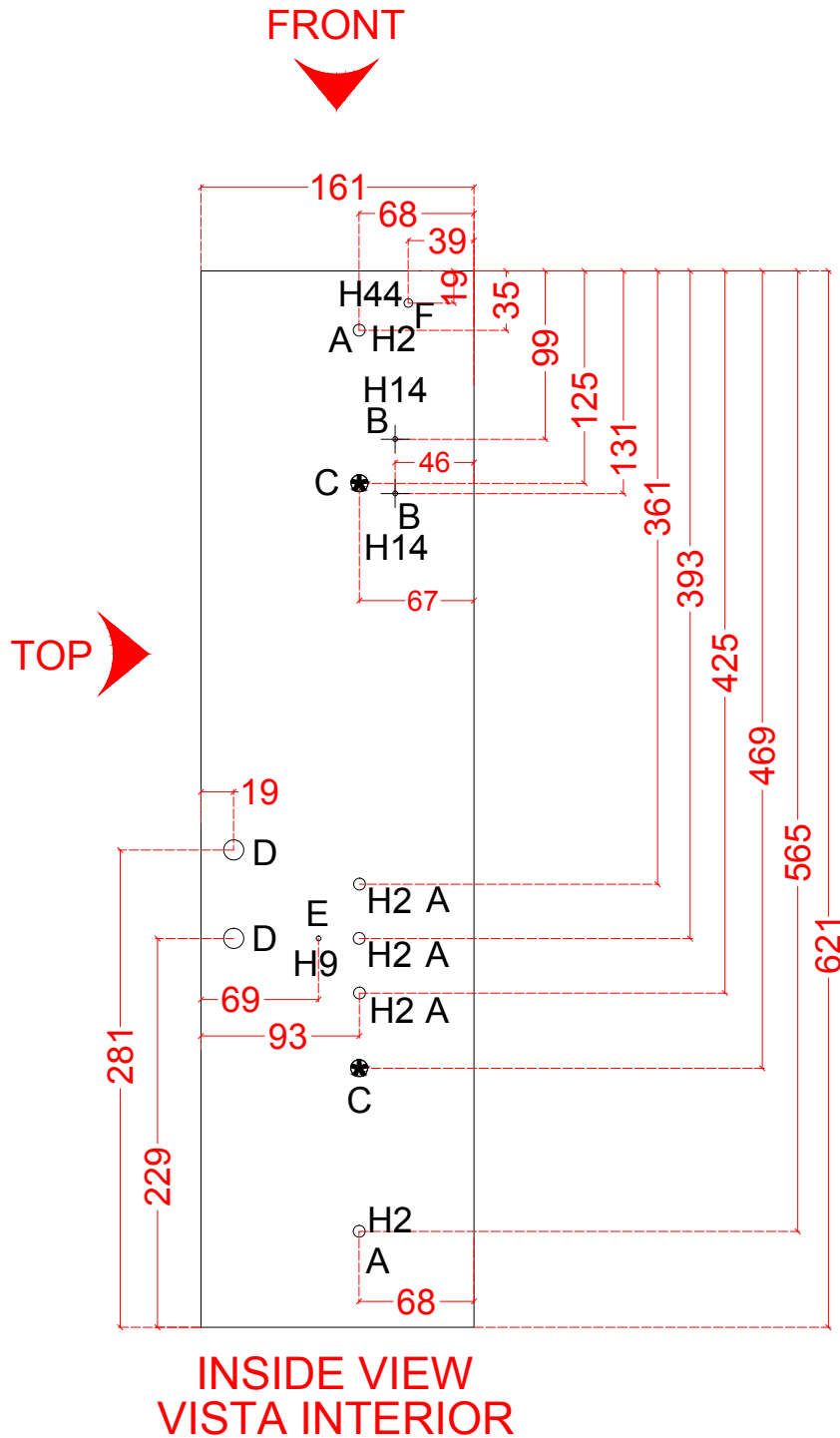

SCREW HEADS

H2 5 x 2

H9 1 x 2

PERFORATION

A	7	PASS
B	3	2
C	10	16
D	12	PASS
E	3	15
F	5	11



CONFIDENTIAL DRAWINGS
ALL REPRODUCTION PROHIBITED

Mecanismo Vancouver

TD 06 MA 1500 x 1900 CQU

MA 1900-1500-348-326

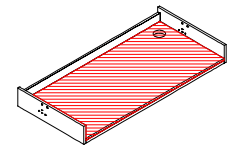

Part: Desk Top (15)

Material: MDF

Thick: 18mm

Quantity: 1

SCREW HEADS

○ 2 X 2



PERFORATION

A	5.5	70
B	10	22
C	5	12

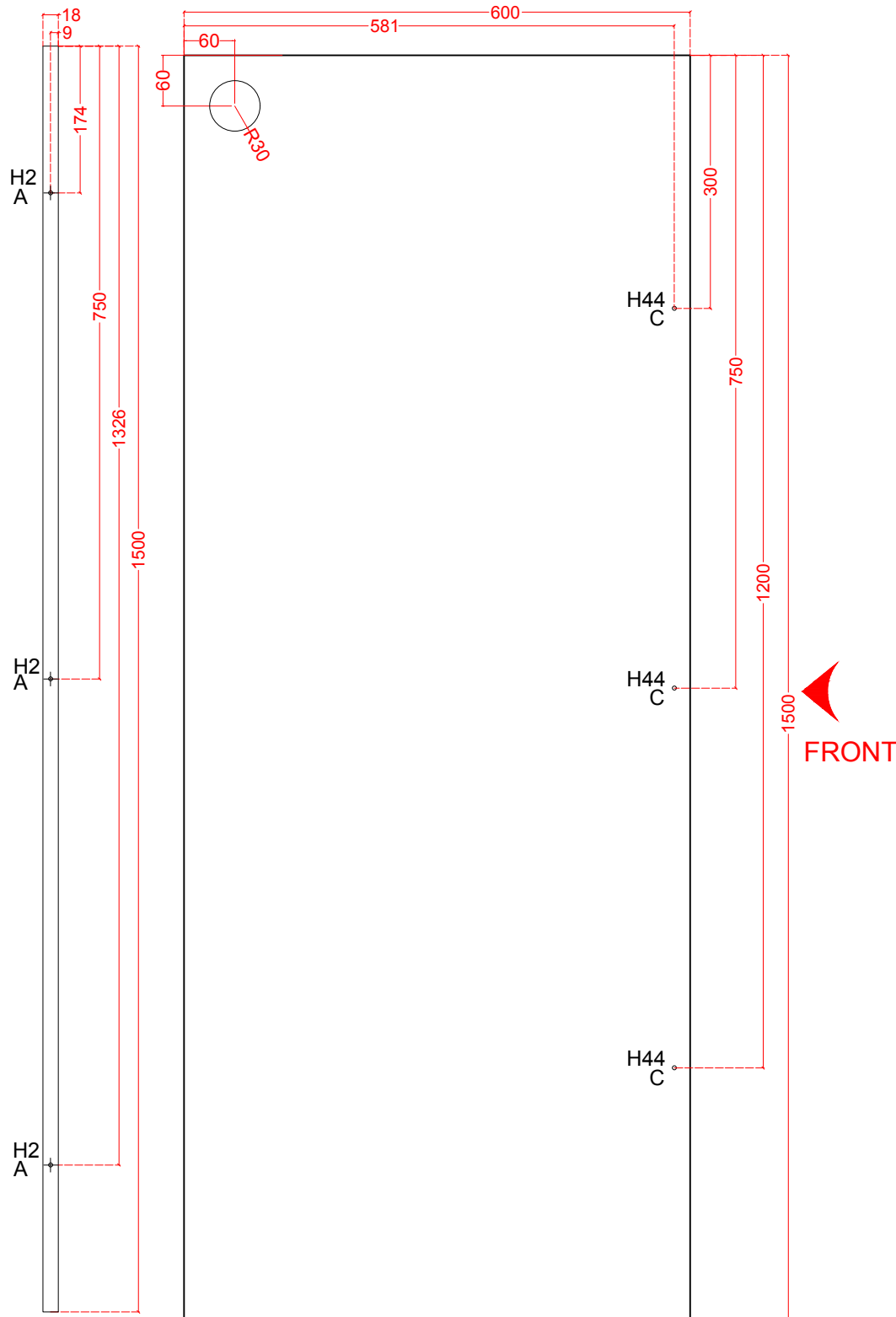

**BOTH ENDS
AMBOS EXTREMOS**

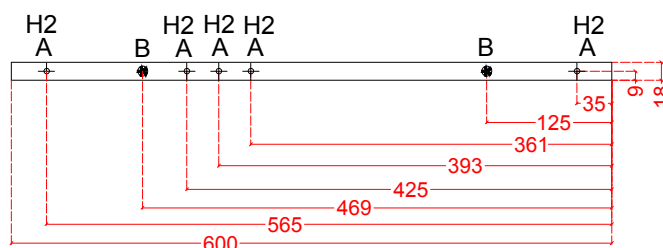

CONFIDENTIAL DRAWINGS
ALL REPRODUCTION PROHIBITED

Mecanismo Vancouver

TD 06 MA 1500 x 1900 CQU

MA 1900-1500-348-326

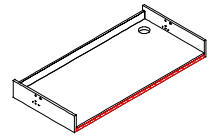

Part: Desk Tube Cover(17)

Material: MDF

Thick: 18mm

Quantity: 1

SCREW HEADS

H44	5
-----	---

PERFORATION

A	8	24
B	12	10.2

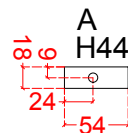
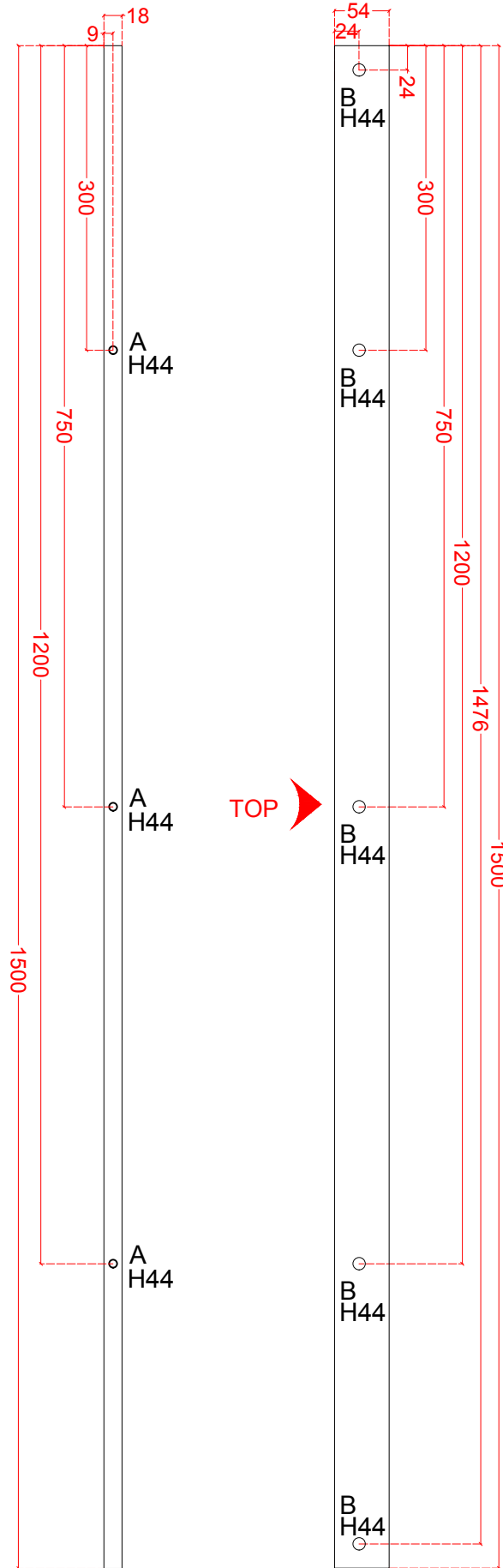

**BOTH ENDS
AMBOS EXTREMOS**



CONFIDENTIAL DRAWINGS
ALL REPRODUCTION PROHIBITED

Mecanismo Vancouver

TD 06 MA 1500 x 1900 CQU

MA 1900-1500-348-326

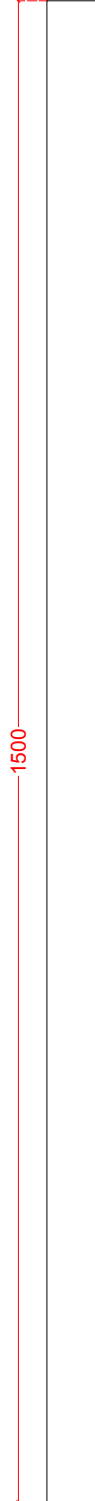
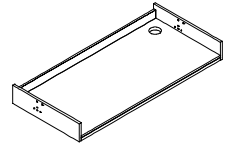

Part: Desk Tube (18)

Material: Steel Tube

Thick: 25 x 50 x 1.5

Quantity: 1

SCREW HEADS

PERFORATION

PLUGS TO SUPPORT DESK TUBE: SEE DRAWING 21b



CONFIDENTIAL DRAWINGS
ALL REPRODUCTION PROHIBITED

Mecanismo Vancouver

TD 06 MA 1500 x 1900 CQU

MA 1900-1500-348-326

